

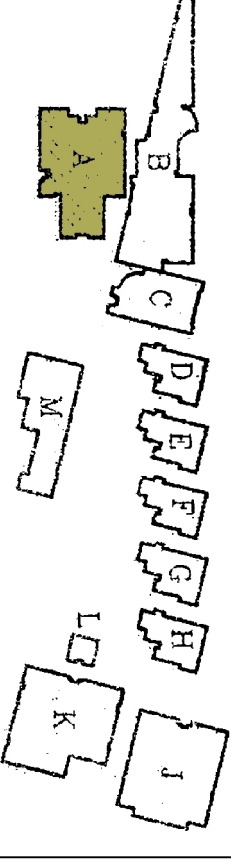

**GROUND FLOOR - FLOOR PLAN**  
SCALE: 1/4"=1'-0"

- FLOOR PLAN KEYNOTES**
- ① NON-RATED GLASS DOORS
  - ② NON-RATED GLASS PARTITION
  - ③ RECEPTION COUNTER WITH PASS THROUGH
  - ④ STORAGE SHELVING

**KEY PLAN**



**reset studios, ll.c.**  
407 west osborn, suite 200  
phoenix, arizona 85013  
p: 602.254.5082  
f: 602.254.5083  
george@resetstudios.com

**CITY PERMIT REVIEW**

This drawing is an instrument and property of RESET STUDIOS, LLC, and may not be reproduced without written permission.

MINOR RENOVATIONS AND TENANT IMPROVEMENT PROJECT  
**Child Abuse Prevention Foundation & HomeAid**

08.06.08  
FIRST MEETING

**FLOOR PLAN**

**A1**

These drawings, an unpublished instrument of service of Reset Studios, LLC, and associated authors, is for use on this Project only and is prepared for use in conjunction with the author's interpretations, observations, decisions, and administration as described in AIA Doc. A201, without which desired results can not be obtained. Attention, reproduction, or use in part or in whole, for other purposes without the author's expressed written consent may violate AIA Doc. A201, par. 301 (1991). All rights reserved, 2008 ©